

Fire Rated Gypsum Board Partition Systems

1-hours fire Rated Gypsum Board Partition (12mm)

Fire resistance	FRL	-/60/60
	Standard	BS 476: Part 20: 1987 BS 476: Part 22: 1987
	Approval	R10C17 RED
Assessment	Approval	R17K09 - 1A - Issue 1 R23D03 - 1A (RED)
	Maximum height	Up To 6m
	Partition thickness	74mm-124mm
Acoustic	#STC	STC - 48
	Standard	ASTM E 90 ASTM E 413-87
	Predicted assessment	ATS 05-005-RP003 (ATSL)
Physical Performance	EN 520 BS 476: Part 4, 6 & 7	

#Acoustic STC-48 is generally used with Rock wool 100kg/m³ 50mm thick

- ① One layer of 12mm thick BNBM (fire resistant Gypsum plasterboard)
- ② BNS Rock wool 50mm x 60kg/m³
- ③ 50mm x 32mm x 0.55mm thick Galvanized Steel U Channel at nominal 610mm
- ④ 50mm x 25mm x 0.55mm thick Galvanized Steel C Channel
- ⑤ Self-tapping screws at 250mm centres
- ⑥ Fire Sealant

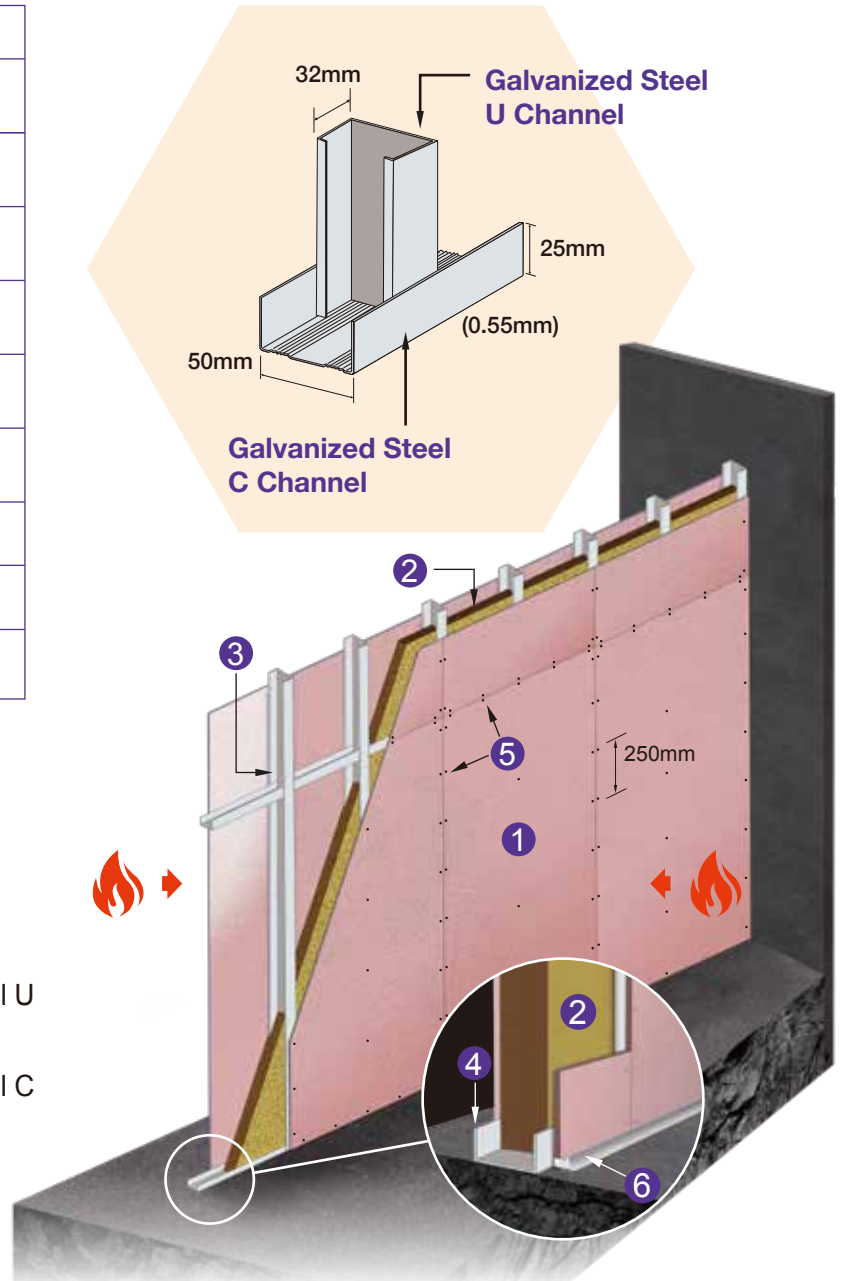

Sizes of studs for the proposed height of partition boards wall systems

Height up to	Stud sizes (D×F×T)	Studs spacing	Expansion allowance	
Up to 4m	50×32×0.55mm	610mm/ c/c	40mm	
4.0m < Height	4.5m	75×32×1.0mm	610mm/ c/c	45mm
4.5m < Height	5.5m	75×50×1.0mm	610mm/ c/c	55mm
		100×32×1.0mm		
5.5m < Height	6.0m	75×50×1.2mm	610mm/ c/c	55mm
		100×50×1.0mm		